



**The Timken Company**  
 4500 Mt Pleasant St. NW  
 N. Canton, OH 44720  
**Phone:** (234) 262-3000  
**E-Mail:** [CustomerCAD@timken.com](mailto:CustomerCAD@timken.com) • **Web site:** [www.timken.com](http://www.timken.com)

## Timken Part Number UC215, UC Setscrew Wide Inner Ring Ball Bearings

RELATED PRODUCTS

RELATED PRODUCTS

RELATED PRODUCTS

RELATED PRODUCTS

RELATED PRODUCTS

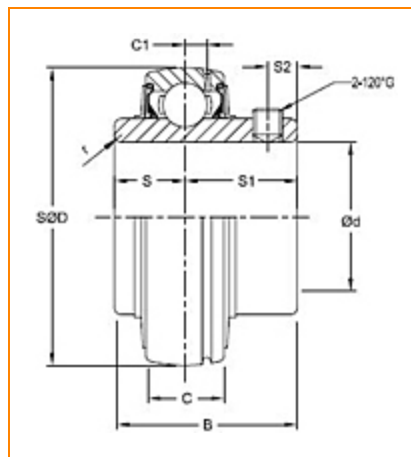

[Specifications](#) | [Dimensions](#) | [Basic Load Ratings](#)

### Specifications

Item #	UC215
Bore Type	Cylindrical bore
Bearing Type	Ball Bearing
Bore Size d	75 mm
Material	Bearing Steel

<b>Weight</b>	4.9 lb 2.2 Kg
---------------	------------------

## Dimensions

<b>Outside Diameter D</b>	130.000 mm 5.118 in
<b>Inside Ring Width B</b>	77.8 mm 3.063 in
<b>Outside Ring Width C</b>	32.000 mm 1.260 in
<b>Radius r</b>	1.5 mm 0.059 in
<b>Groove Position C1</b>	9.00 mm 0.354 in
<b>Center of Bearing from End S</b>	33.3 mm 1.311 in
<b>Dimension S1</b>	44.5 mm 1.752 in
<b>Set Screw Distance S2</b>	12.00 mm 0.472 in
<b>Set Screw Size</b>	M12×1.5
<b>Number of Set Screws</b>	2
<b>Angle between Set Screws</b>	120 °

## Basic Load Ratings

<b>Static Load Rating</b>	10858 lbf 48300 N
<b>Dynamic Load Rating</b>	15152 lbf 67400 N



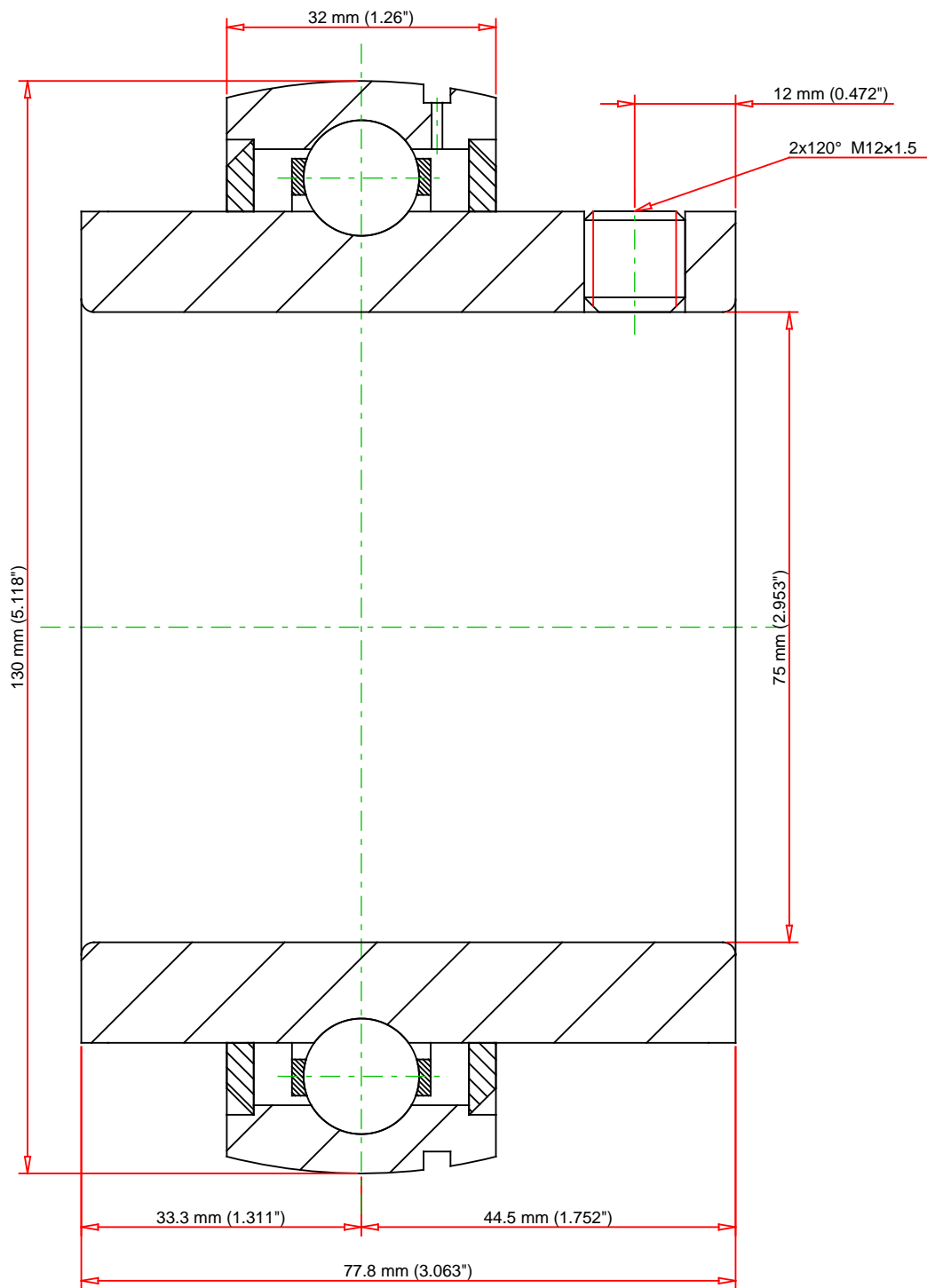

Weight	4.9 lb	2.2 kg
--------	--------	--------

**TIMKEN®**

**THE TIMKEN COMPANY**  
NORTH CANTON, OHIO USA

**UC215**

UC Setscrew Wide Inner Ring Ball Bearings

Basic Load Ratings - C <sub>r</sub>	15152 lbf	67400 N
Load Ratings - C <sub>0r</sub>	10858 lbf	48300 N

Every reasonable effort has been made to ensure the accuracy of the information contained in this writing, but no liability is accepted for errors, omissions or for any other reason.

**FOR DISCUSSION ONLY**