

Type D1a

Drive-in Flush-Type Grease Nipples



- according to DIN 3405
- straight version A / 180°
- drive-in-type with plain shank
- standard versions according to DIN are made of steel, zinc-plated and passivated
- for further types and materials, please see table, or upon request

B collar Ø  
L1 shank length  
L2 total length  
Z shank Ø  
(all measures in mm)

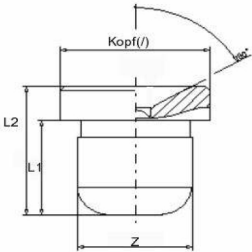

B 8				Ref.- No.:			
L1	L2		shank Ø	steel	brass	V2A	V4A
5,5	7,5		5 mm				
			6 mm				
			6,35 mm; 1/4"				

B 10				Ref.- No.:			
L1	L2		shank Ø	steel	brass	V2A	V4A
6,5	9,5		8 mm				

B 12				Ref.- No.:			
L1	L2		shank Ø	steel	brass	V2A	V4A
6,5	9,5		10 mm				

Type D2a

Drive-in Flush-Type Grease Nipples



- according to DIN 3405
- angled version B / 45°
- drive-in-type with plain shank
- standard versions according to DIN are made of steel, zinc-plated and passivated

SW wrench size  
L1 shank length  
L2 total length  
Z shank Ø  
(all measures in mm)

