

# Series™ Heavy Duty Precision Ground Radial Bearings with Extended Inner Ring

- **PRECISION GROUND ON ALL CONTACT SURFACES, SIMILAR TO THE 1600 SERIES™ BEARINGS**
- **EASY TO USE INCH DIMENSIONS**
- **MEDIUM LOADS**
- **MAX SPEED RANGE - 5000 - 6000 RPM**
- **THROUGH HARDENED**
- **CAGED DESIGN**
- **NYLON CAGE STANDARD**
- **DOUBLE SEALED STANDARD**
- **HIGHLY EFFICIENT SINGLE LIP CONTACT SEAL**
- **AVAILABLE SINGLE SEALED OR OPEN**
- **EXTENDED INNER RING WITH SET SCREWS**
- **ALL BEARINGS HAVE A SNAP RING GROOVE, SNAP RING ASSEMBLED AS AN OPTION**
- **RECOMMENDED FOR APPLICATIONS WHERE ACCURATE, QUIET PERFORMANCE AND SUPERIOR SEALING ARE REQUIRED**



BEARING ①	PRINCIPLE DIMENSIONS						
	BORE	O.D.	WIDTH	A	F	G	
	d (in) (mm) +.0008 +.020 -.0000 -.000	D (in) (mm) +.0000 +.000 -.0005 ② -.013	B (in) (mm) +.000 +.00 -.005 -.13	(in) (mm)	(in) (mm)	(in) (mm) +.005 +.13 -.005 -.13	
7608™	.5000 12.70	1.7500 44.45	0.6250 15.88	0.0625 1.59	1.009 25.63	0.136 3.45	
7609™	.5625 14.29	1.7500 44.45	0.6250 15.88	0.0625 1.59	1.009 25.63	0.136 3.45	
7610™	.6250 15.88	1.7500 44.45	0.6250 15.88	0.0625 1.59	1.009 25.63	0.136 3.45	
7611™	.6875 17.46	1.7500 44.45	0.6250 15.88	0.0625 1.59	1.009 25.63	0.136 3.45	
7612™	.7500 19.05	1.7500 44.45	0.6250 15.88	0.0625 1.59	1.009 25.63	0.136 3.45	
7613™ ②	.8125 20.64	2.0000 50.80	0.6250 15.88	0.0625 1.59	1.306 33.17	0.136 3.45	

① When ordering please indicate designation and style letters of bearing desired (i.e. DL or DLG)

② Tolerance for 7613™ and larger is +.0000/-.0006 (+.000/-.015)

③ Radius R indicates the maximum fillet radius in housing or shaft which bearing will clear

④ Weights given are for greased and sealed versions

All bearing designations listed herein are trademarks of RBC Nice® Bearings.

**7600**

# Series™ Heavy Duty Precision Ground Radial Bearings with Extended Inner Ring

The 7600 Series™ bearings are single row retainer type radial bearings similar in construction to the 1600 Series™ bearings. They incorporate a highly efficient single lip contact seal with metal guard. The inner and outer rings are turned from chrome steel and after careful heat treatment the through hardened rings are accurately ground to close tolerances. The inner ring is extended and contains set screws whereas the 7500 Series™ bearing does not.

The 7600 Series™ bearings are recommended for applications requiring the accuracy of rotation and quiet performance of close limit precision grade bearings, and where a superior seal is required to retain lubricant and keep the bearing free from dust and dirt.

Normally double sealed (type DL), the 7600 Series™ bearings can be produced to order with seals on one side only (type SL) or without seals (type NL). Double sealed bearings are grease packed as standard; however, all types can be furnished with or without grease packing as desired. All types are provided with a snap ring groove, with the snap ring assembled on the bearing as an option.

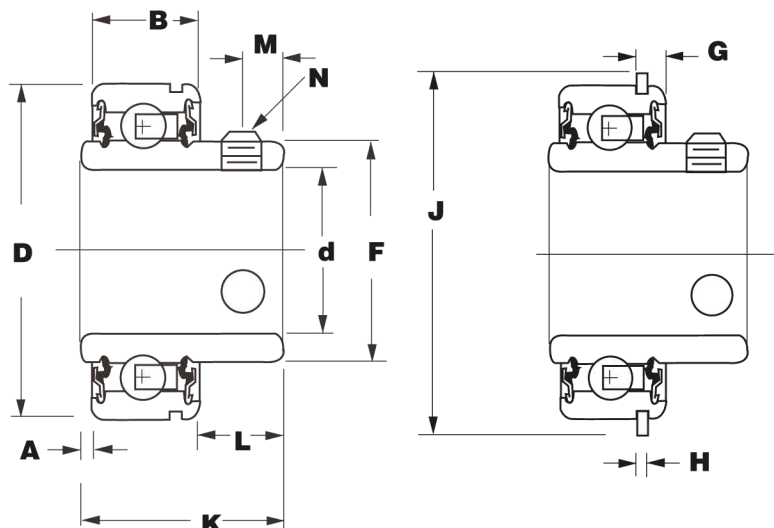

PRINCIPLE DIMENSIONS								BASIC LOAD RATINGS		WEIGHT
	H (in) (mm)	J (in) (mm)	K (in) (mm) +.000 +.00 -.005 -.13	L (in) (mm)	M (in) (mm)	N 2 set screws	Radius <sup>3</sup> R (in) (mm)	Dynamic C (lbs) (N)	Static C <sub>o</sub> (lbs) (N)	W <sup>4</sup> (lbs) (kg)
	0.042 1.07	1.922 48.82	1.092 27.74	0.405 10.29	0.233 5.92	10-32	0.035 0.89	2595 11548	1025 4561	0.36 0.16
	0.042 1.07	1.922 48.82	1.092 27.74	0.405 10.29	0.233 5.92	10-32	0.035 0.89	2595 11548	1025 4561	0.34 0.15
	0.042 1.07	1.922 48.82	1.092 27.74	0.405 10.29	0.233 5.92	10-32	0.035 0.89	2595 11548	1025 4561	0.32 0.15
	0.042 1.07	1.922 48.82	1.092 27.74	0.405 10.29	0.233 5.92	10-32	0.035 0.89	2595 11548	1025 4561	0.30 0.14
	0.042 1.07	1.922 48.82	1.092 27.74	0.405 10.29	0.233 5.92	10-32	0.035 0.89	2595 11548	1025 4561	0.28 0.13
	0.042 1.07	2.156 54.77	1.179 29.95	0.492 12.50	0.261 6.63	1/4-28	0.035 0.89	2970 13217	1350 6008	0.45 0.20